

Urban design drawings

Joe Holyoak

Image credits

- n Illustrations from Bally Meeda, Neil Parkyn and Stuart Wilson, *Graphics for urban design*, Thomas Telford Publishing, 2007
- n Also, *Design Drawing* by Francis Ching



Observation and analysis, roughly traced over base map

Stevenage



Oxford



Banbury



Stratford-upon-Avon



Comparative figure/
ground plans

Simple coded
proposals drawing

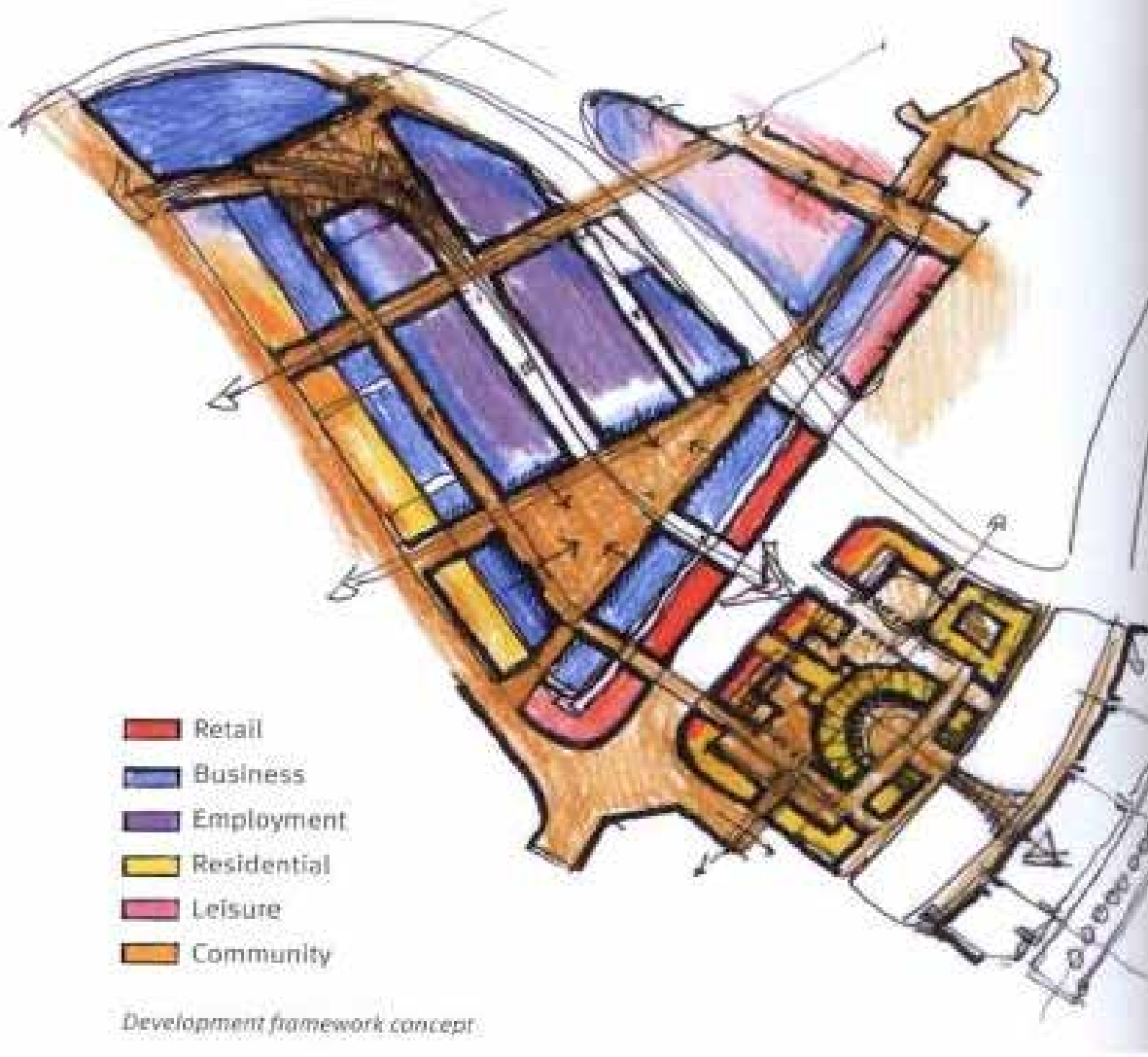



Diagrammatic proposals drawing

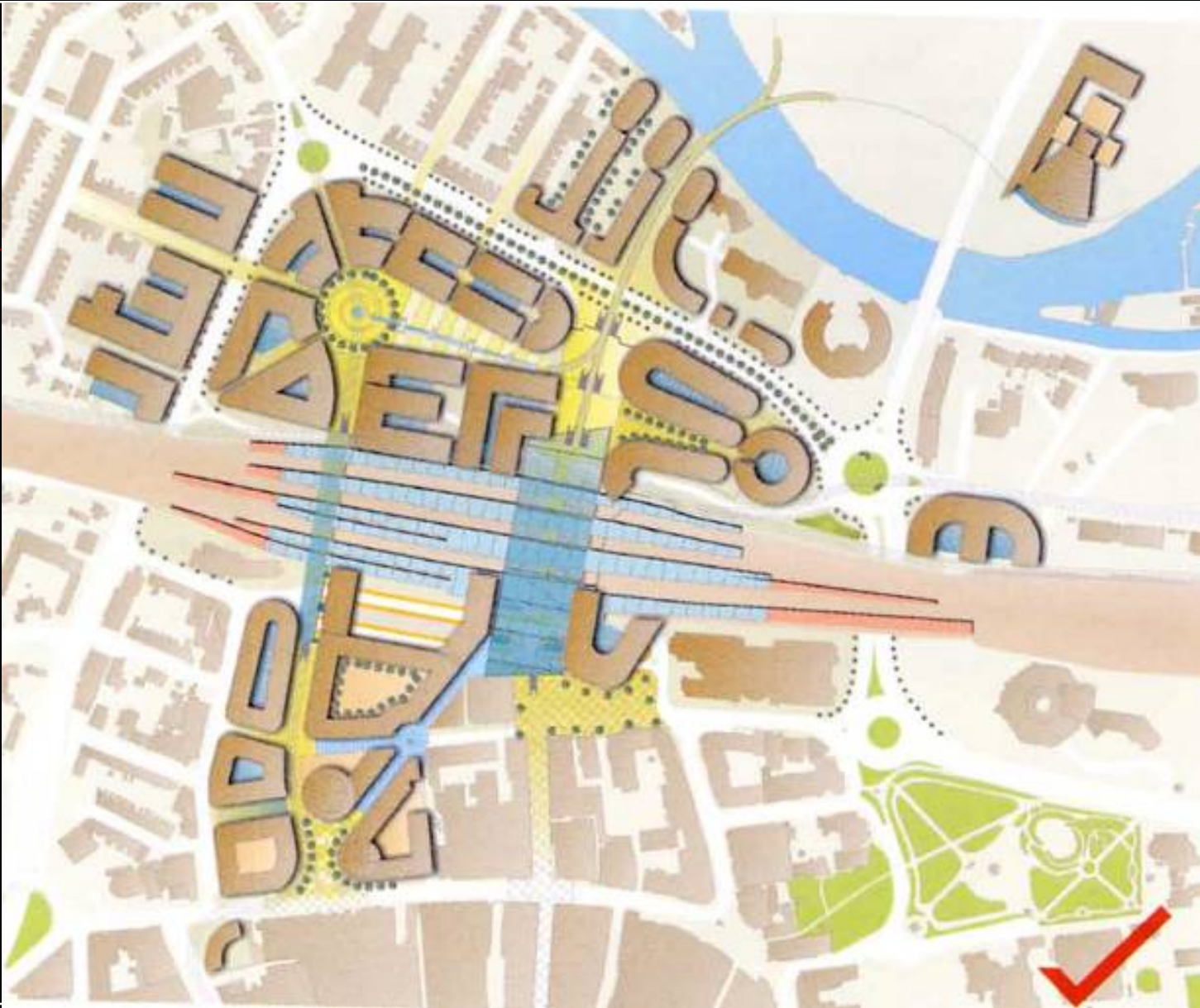

Existing and proposed are differentiated by tone; extraneous detail is removed from background

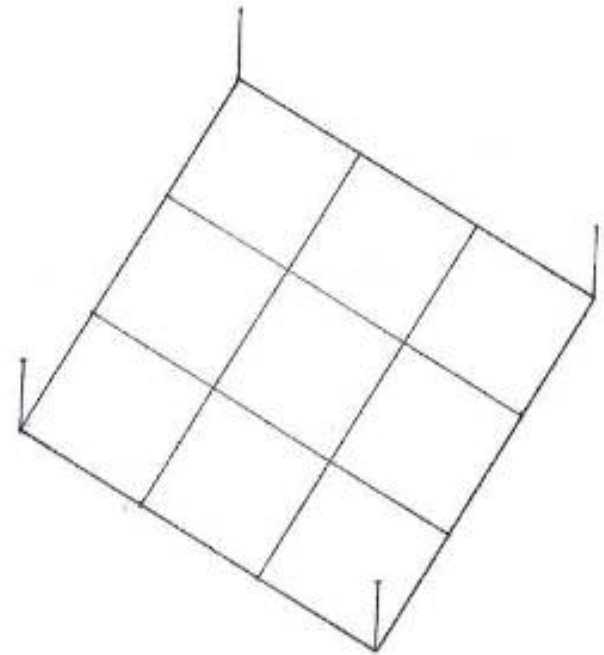
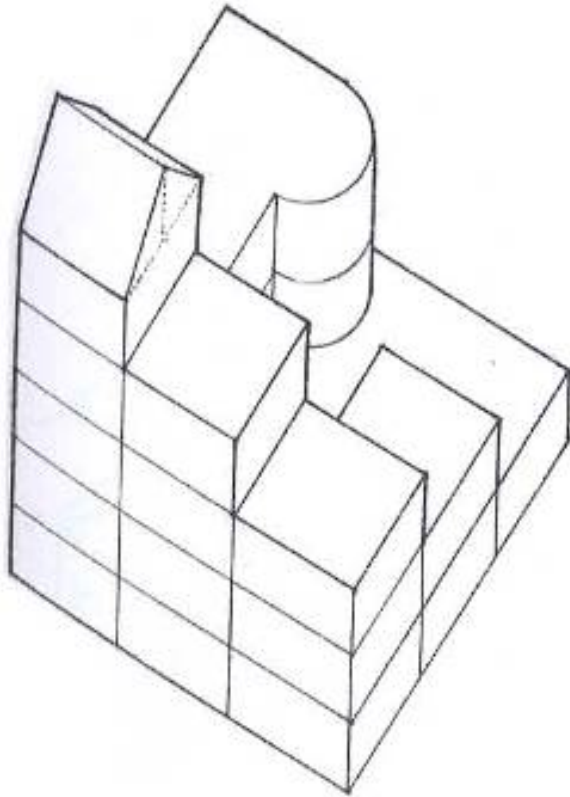

Axonometric; producing 3-dimensional form from the plan



Master plan
drawn in
axonometric
from the plan;
heights of
buildings are
drawn to scale

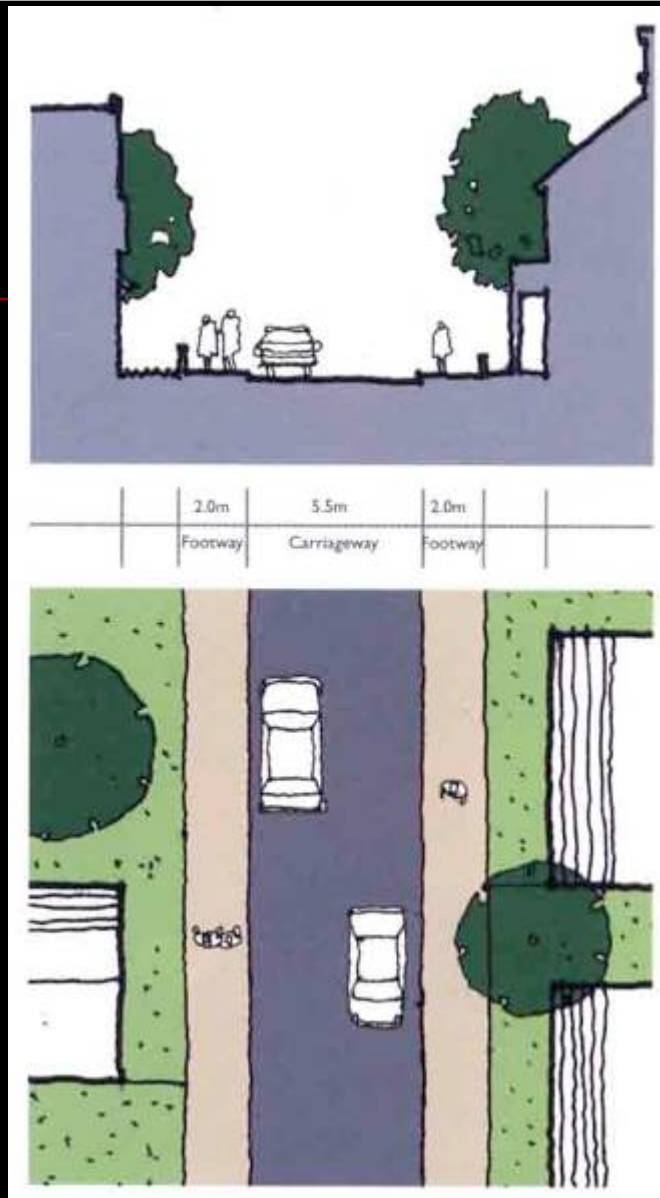

Street section and plan; section shows degree of spatial enclosure

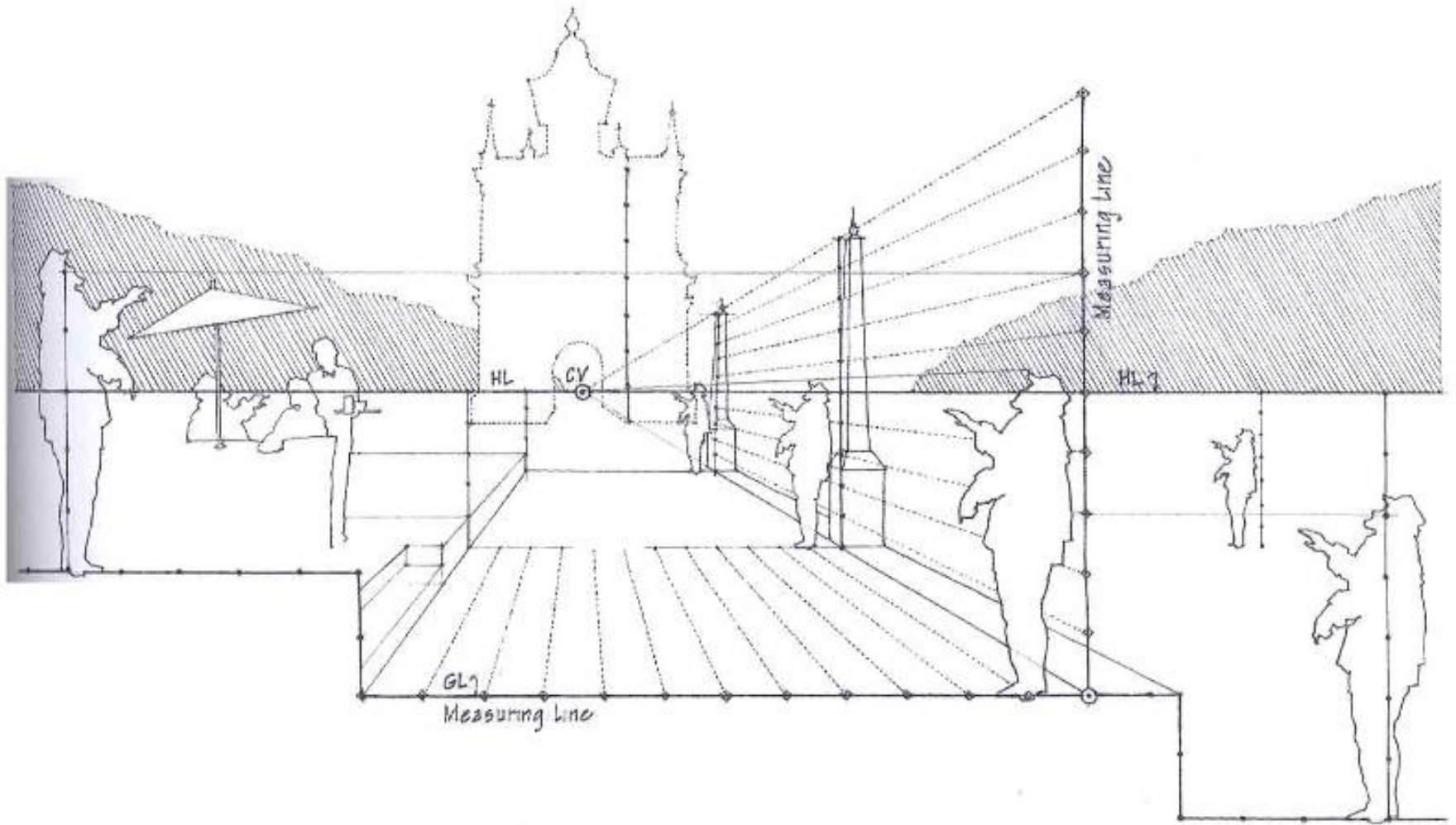

Single-point perspective combined with section.

Establish the eye level

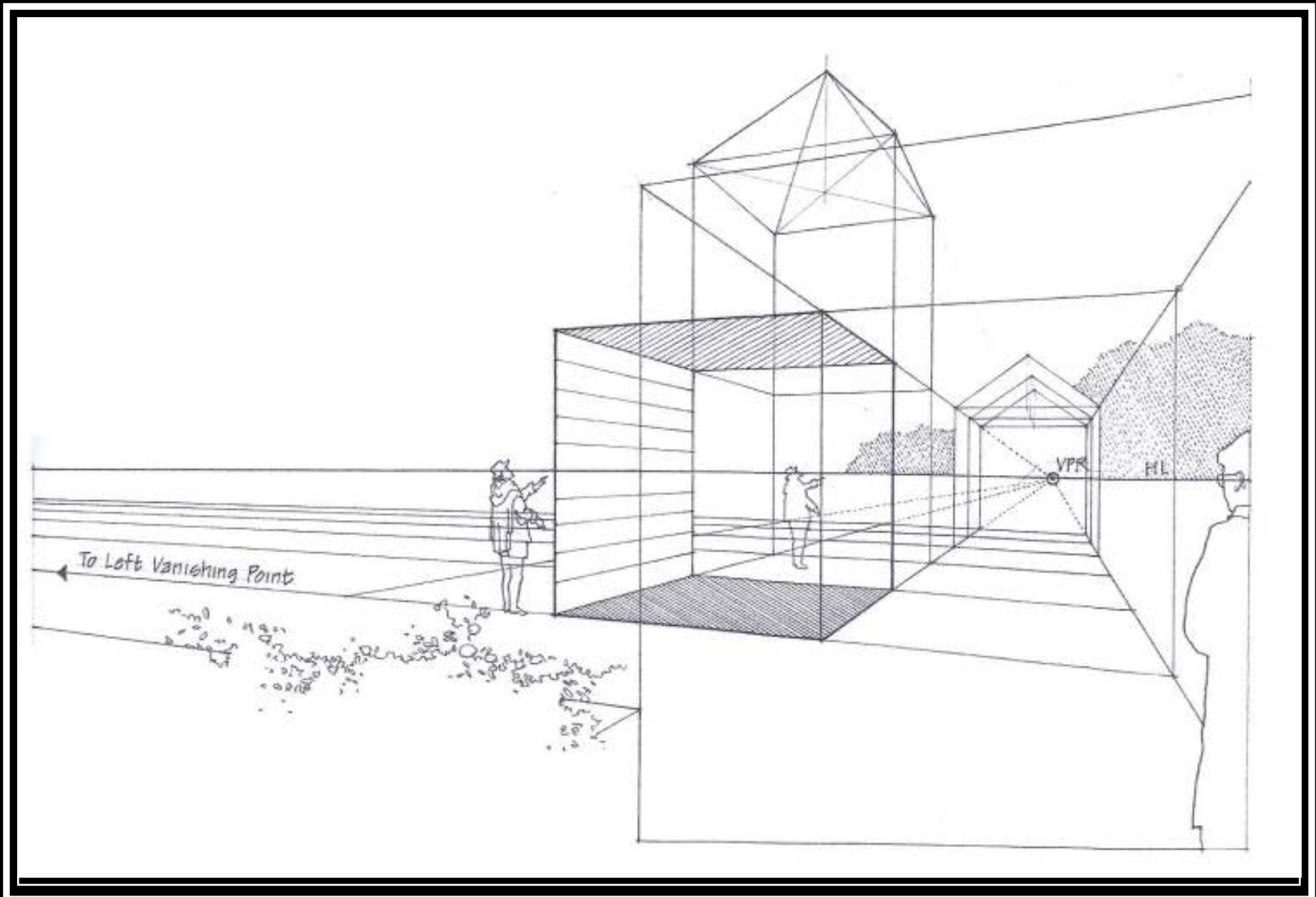

Two-point perspective; drawn from standing eye level, again all eyes are on the eye level



Higher intervention option incorporating redevelopment and environmental improvements



Low intervention option incorporating improvements to buildings, streets and public spaces



View into Robert Gordon University



The green looking towards the refurbished Aberdeen Market

Simply drawn perspectives, traced from photographs, show recognisable places